



規格承認書

(SPECIFICATION FOR APPROVAL)

File No.: Q/BH .TS16949.13TECH1303

Product Name: Metallized polypropylene film capacitor for lamps
Product Type: C62(CBB60L 灯具电容器)
Product Code: C62
Customer:
Customer Code:
Issue Date: (V3.0)

金属化聚丙烯膜灯具电容器 Metallized polypropylene film capacitor for lamps

■ 外形图 Outline Drawing

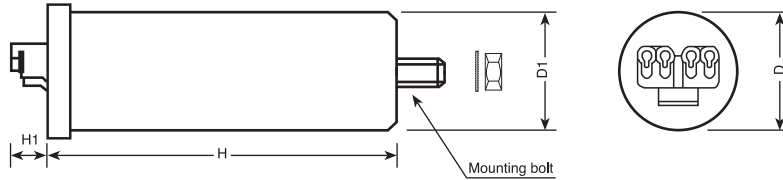



■ 特点

广泛用于荧光灯、高压汞灯、钠灯、金属卤素灯等以频率为50Hz/60Hz的交流电源供电的照明灯具中的变压器、电子镇流器的功率因数补偿，使灯具的功率因数 $\cos\phi \geq 0.9$

■ Features

The capacitors are designed for lighting applications such as fluorescent lamps, high-pressure mercury vapour lamps, sodium lamps, and metal halide lamps. The capacitors are used for power factor compensation of transformers and magnetic ballasts in lamps with a frequency of 50 or 60Hz, which makes the power factor to achieve $\cos\phi \geq 0.9$.

■ 安全认证 Safety Approvals

●		CQC (中国)	GB 18489-2008, type A, 2.0 μ F ~ 50.0 μ F, 250Vac, 50/60Hz, -40/85 $^{\circ}$ C 证书号(Certificate No.): CQC040000092
●		TUV Rheinland (德国)	EN 61048:2006, type A, 2.0 μ F ~ 50.0 μ F, 250Vac, 50/60Hz, -40/85 $^{\circ}$ C 证书号(Certificate No.): R 501604

■ 技术要求 Specifications

引用标准 Reference Standard	GB 18489-2008(IDT IEC 61048-2006) GB/T 18504-2001(IDT IEC 61049-1991); EN 61048: 2006
额定电压 Rated Voltage (U_n)	250Vac
额定频率 Rated Frequency (f_n)	50/60Hz
容量范围 Capacitance Range (C_n)	2.0 μ F~ 50.0 μ F
容量等级 Capacitance Tolerance	$\pm 5\%$, $\pm 10\%$
额定最高温度(电容器表面温度, t_c) Rated Max. Temperature (on capacitor surface, t_c)	85 $^{\circ}$ C
气候类别 Climatic Category	40/85/10
电容器类别 Type	Type A (self-healing parallel capacitor)
外壳类型 Case	Plastic or aluminum
凝露 Condensation	Not permitted
耐电压(引线之间) Test Voltage Between Terminals	500Vac, 2s
耐电压(极壳之间) Test Voltage Between Terminal to Case	2 000Vac, 2s (max. leakage current: 0.5mA)
最大工作电压 Max. Operating Voltage	275Vac
额定电流 Rated Current(I_n)	0.0785 C_n (A)@50Hz 0.0942 C_n (A)@60Hz (Unit of C_n : μ F)
最大工作电流 Max. Operating Current	1.3 I_n
外壳防护等级 Degree of protection	IP00
电极端子 Terminals	Push in connector or Insulated wires
连接线 Connect Wires	Insulated rigid leads 0.5~1.0mm ² , approx. stripped 6~7mm
底部固定螺栓 Bottom Mounting bolts	M8
最大安装扭矩 Max.Torque of Installation	3Nm
最高使用海拔 Max Altitude	2 000m



C62
CBB60L series

产品编码说明 Part number system

■ 18位产品代码如下:

The 18 digits part number is formed as follow:

1	2	3	4	5	6	7	8	9	10	11	12	13	14	15	16	17	18
C	6	2															

第1~3位	型号代码	Digit 1 to 3	Series code
	C62=CBB60L		C62=CBB60L
第4~5位	交流额定电压	Digit 4 to 5	AC rated voltage
	E2=250V		E2=250V
第6~8位	标称容量	Digit 6 to 8	Rated capacitance value
	举例: 505=50 x 10 ⁵ pF=5.0μF		For example: 505=50 x 10 ⁵ pF=5.0μF
第9位	容量偏差	Digit 9	Capacitance tolerance
	K= ± 10%		K= ± 10%
第10位	产品外形尺寸代码	Digit 10	Dimension code

CBB60L Dimension code					
D	H	Code	D	H	Code
25	58	1	40	95	7
30	58	2	45	100	8
30	68	3	45	125	9
30	73	4	45	66	A
30	98	5	45	95	B
35	95	6			

第11位	内部特征码	Digit 11	Internal use
第12~15位	引出端代码	Digit 12 to 15	Terminals code
第16~18位	内部特征码	Digit 16 to 18	Internal use

■ Table 1 引出端代码 Terminals code

第12位 Digit 12		第13位 Digit 13		第14位 Digit 14		第15位 Digit 15	
Code	引出端形式 Terminal form	Code	安装形式 Fixed style	Code	引出端长度 Length of lead wire	Code	是否有放电电阻 With or without discharge resistor
B	UL1015绝缘线 剥线式 UL1015 insulated lead wire	5 8	下部螺栓M8 Bottom-bolt M8 中部卡圈 Ring-clip in the middle of case	0 8	标准长度 standard length 8英寸 8 inch (1 inch=25.4mm)	R	With resistor
	0					Without resistor	
G	插入式端子 insert terminal						



C62
CBB60L series

■ 外形尺寸 Dimensions(mm)

250Vac							
C _n (μF)	D ±2.0	D1 ±2.0	H ±3.0	H1 ±1.0	Mounting bolt	Discharge resistor	Part number
2.0	25	25	58	12	M8x10	0.5W,1.2MΩ	C62E2205-10****+++
2.5	25	25	58	12	M8x10	0.5W,1.2MΩ	C62E2255-10****+++
3.0	25	25	58	12	M8x10	0.5W,1.2MΩ	C62E2305-10****+++
3.5	25	25	58	12	M8x10	0.5W,1.2MΩ	C62E2355-10****+++
4.0	25	25	58	12	M8x10	0.5W,1.2MΩ	C62E2405-10****+++
4.5	25	25	58	12	M8x10	0.5W,1.2MΩ	C62E2455-10****+++
5.0	25	25	58	12	M8x10	0.5W,1.2MΩ	C62E2505-10****+++
5.5	30	29	58	12	M8x10	0.5W,1.2MΩ	C62E2555-20****+++
6.0	30	29	58	12	M8x10	0.5W,1.2MΩ	C62E2605-20****+++
6.3	30	29	58	12	M8x10	0.5W,1.2MΩ	C62E2635-20****+++
6.5	30	29	58	12	M8x10	0.5W,1.2MΩ	C62E2655-20****+++
7.0	30	29	58	12	M8x10	0.5W,1.2MΩ	C62E2705-20****+++
7.5	30	29	58	12	M8x10	0.5W,1.2MΩ	C62E2755-20****+++
8.0	30	29	68	12	M8x10	0.5W,1.2MΩ	C62E2805-30****+++
8.4	30	29	68	12	M8x10	0.5W,1.2MΩ	C62E2845-30****+++
8.5	30	29	68	12	M8x10	0.5W,1.2MΩ	C62E2855-30****+++
9.0	30	29	68	12	M8x10	0.5W,1.2MΩ	C62E2905-30****+++
9.5	30	29	68	12	M8x10	0.5W,1.2MΩ	C62E2955-30****+++
10	30	29	68	12	M8x10	0.5W,1.2MΩ	C62E2106-30****+++

250Vac							
C _n (μF)	D ±2.0	D1 ±2.0	H ±3.0	H1 ±1.0	Mounting bolt	Discharge resistor	Part number
12	30	29	73	12	M8x10	0.5W,1.2MΩ	C62E2126-40****+++
12.5	30	29	98	12	M8x10	0.5W,1.2MΩ	C62E212E-50****+++
13	30	29	98	12	M8x10	0.5W,1.2MΩ	C62E2136-50****+++
14	30	29	98	12	M8x10	0.5W,1.2MΩ	C62E2146-50****+++
15	30	29	98	12	M8x10	0.5W,1.2MΩ	C62E2156-50****+++
16	30	29	98	12	M8x10	0.5W,1.2MΩ	C62E2166-50****+++
18	30	29	98	12	M8x10	0.5W,1.2MΩ	C62E2186-50****+++
20	35	34	95	12	M8x10	0.5W,1.2MΩ	C62E2206-60****+++
22	35	34	95	12	M8x10	0.5W,1.2MΩ	C62E2226-60****+++
25	35	34	95	12	M8x10	0.5W,0.75MΩ	C62E2256-60****+++
28	40	38	95	12	M8x10	0.5W,0.75MΩ	C62E2286-70****+++
30	40	38	95	12	M8x10	0.5W,0.75MΩ	C62E2306-70****+++
32	40	38	95	12	M8x10	0.5W,0.75MΩ	C62E2326-70****+++
35	40	38	95	12	M8x10	0.5W,0.75MΩ	C62E2356-70****+++
36	45	44	66	12	M8x10	0.5W,0.75MΩ	C62E2366-A0****+++
40	45	44	95	12	M8x10	0.5W,0.47MΩ	C62E2406-B0****+++
45	45	45	100	16	M8x12	0.5W,0.47MΩ	C62E2456-80****+++
50	45	45	125	16	M8x12	0.5W,0.47MΩ	162E2506-90****+++

备注: 1. “-”表示容量偏差。“-”=capacitance tolerance code, K=±10%, J=±5%
 2. “****”表示引出端代码(见table 1)。“****”=terminals code(refer to table 1)
 3. 其它容量、尺寸系列可按用户需要商定。Other values and dimensions are available on request.